

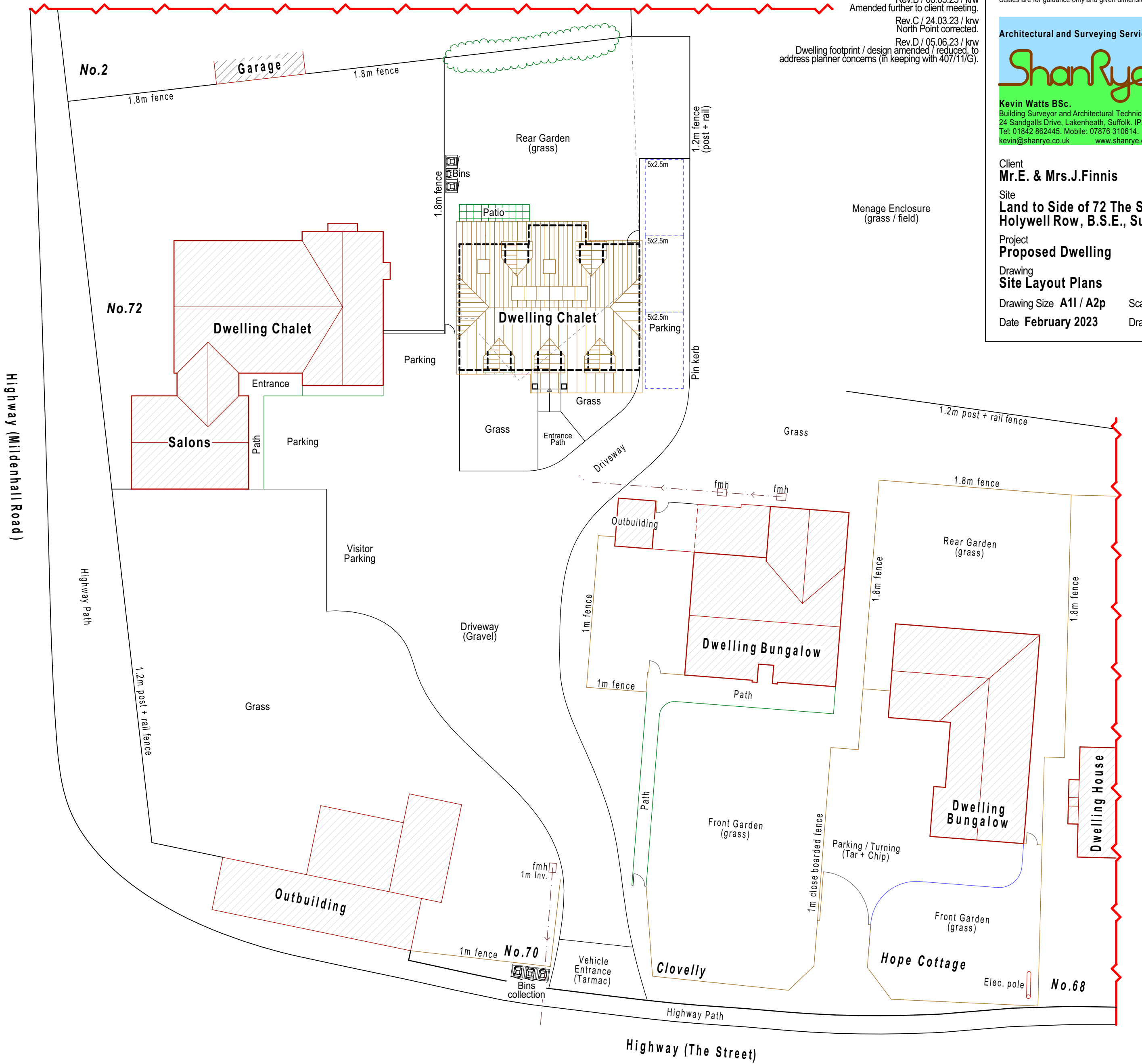

Existing Site Layout Plan

1:200

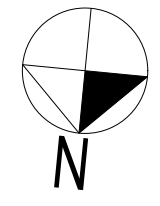
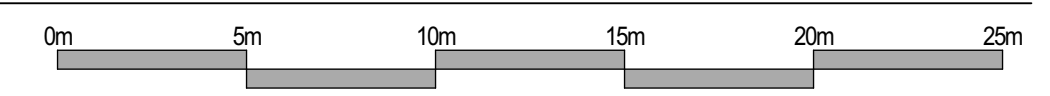

Proposed Site Layout Plan

1:200

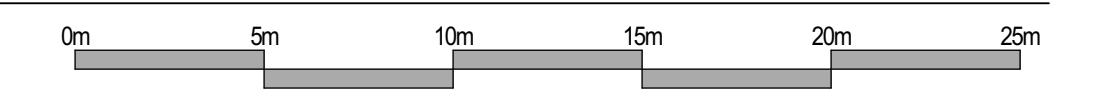

Rev.A / 04.03.23 / knw  
Amended further to client liaison.  
Rev.B / 08.03.23 / knw  
Amended further to client meeting.  
Rev.C / 24.03.23 / knw  
North Point corrected.  
Rev.D / 05.06.23 / knw  
Dwelling footprint / design amended / reduced, to address planner concerns (in keeping with 407/11/G).

This drawing and information within it is the sole property of ShanRye Architectural and Surveying Services and must not be used for reproduction. Please do not scale this drawing. Scales are for guidance only and given dimensions must be used.

**ShanRye**  
Architectural and Surveying Services  
Kevin Watts BSc.  
Building Surveyor and Architectural Technician  
24 Sandgalls Drive, Lakenheath, Suffolk. IP27 9EG.  
Tel: 01842 862445. Mobile: 07876 310614.  
kevin@shanrye.co.uk www.shanrye.co.uk

A friendly professional service at a very competitive price.

Client  
**Mr. E. & Mrs. J. Finnis**  
Site  
**Land to Side of 72 The Street,  
Holywell Row, B.S.E., Suffolk. IP28 8LT**  
Project  
**Proposed Dwelling**  
Drawing  
**Site Layout Plans**  
Drawing Size **A11 / A2p** Scale(s) 1:200  
Date **February 2023** Drawing no. **407/10/D**